

# Quick Installation Guide

AC1900 MU-MIMO Wi-Fi Router

\* Images may differ from actual products.

## 1 Connect the Hardware

- If your internet is from an Ethernet outlet, connect the router's **WAN** port to the Ethernet outlet, then follow Step 4 and 5.
- If you already have a router and want to configure this new router as an access point to extend your network, refer to the **Access Point Mode** section on the back page.

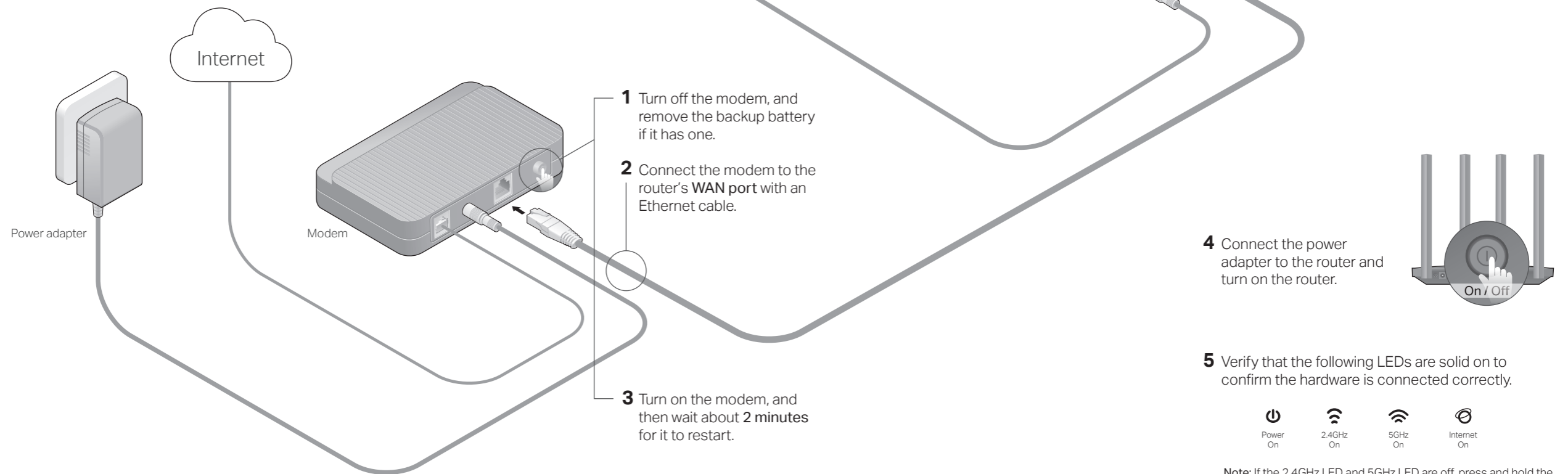

**4** Connect the power adapter to the router and turn on the router.

**5** Verify that the following LEDs are solid on to confirm the hardware is connected correctly.

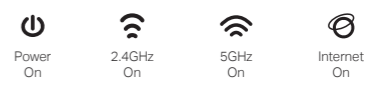

**Note:** If the 2.4GHz LED and 5GHz LED are off, press and hold the WPS/Wi-Fi button on the back for more than 5 seconds. Both the LEDs should turn solid on.

## 2 Set Up the Network

### Method 1: Via TP-Link Tether App

#### 1. Download the Tether app.



#### 2. Connect your smartphone to the router.

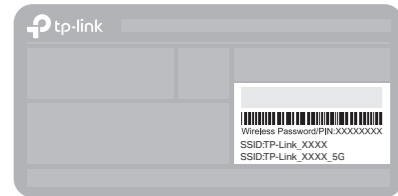

The default wireless network names (SSIDs) and password are printed on the label at the bottom of the router.

#### 3. Connect the router to the internet.

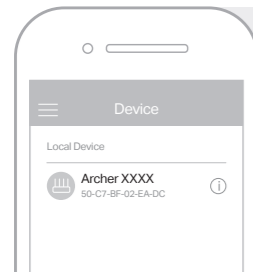

- Launch the Tether app. Select your model from the local device list.
- Create a password to log in.
- Follow the step-by-step instructions to set up the internet connection and register for the TP-Link Cloud service.

😊 Enjoy the internet !

### Method 2: Via a Web Browser

#### 1. Connect your device to the router (wired or wireless).

- Wired**  
Turn off the Wi-Fi on your computer and connect to the router using an Ethernet cable.
- Wireless**
  - Find the SSID and wireless password printed on the label of the router.
  - Click the network icon of your computer or go to Wi-Fi settings of your smart device, and then select the SSID to join the network.

#### 2. Connect the router to the internet.

- Launch a web browser, and enter <http://tplinkwifi.net> or <http://192.168.0.1> in the address bar. Create a password to log in.

Note: If the login window does not appear, please refer to Q1 of Need Help? in this guide.

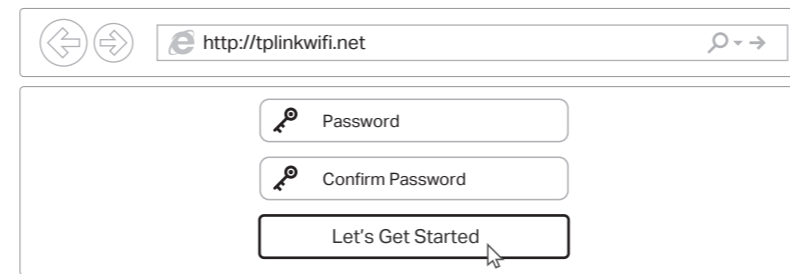

- Follow the step-by-step instructions to set up the internet connection and register for the TP-Link Cloud service.

😊 Enjoy the internet !

## Access Point Mode

If you already have a router, you can switch this new router to Access Point mode to extend your existing network. Follow the steps below.

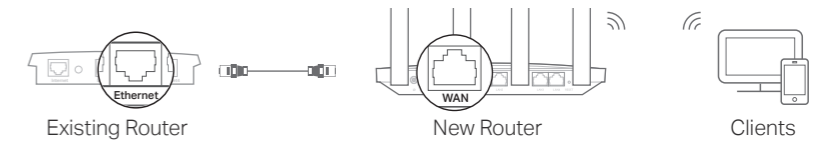

- Power on the router.
- Connect the router's **WAN port** to your existing router's Ethernet port via an Ethernet cable as shown above.
- Connect a computer to the router via an Ethernet cable or wirelessly by using the **SSID** (network name) and **Wireless Password** printed on the label at the bottom of the router.
- Launch a web browser, and enter <http://tplinkwifi.net> in the address bar. Create a password to log in.
- Run the **Quick Setup**, click **Change Mode** in the top right corner then select **Access Point Mode**.  
Note: You can also go to **Advanced > Operation Mode** to switch to **Access Point Mode**.
- Wait for the router to reboot, then log in and follow the **Quick Setup** to complete the setup.

😊 Enjoy the internet !

## Need Help?

#### Q1. What should I do if I cannot access the web management page?

- If the computer is set to a static IP address, change its settings to obtain an IP address automatically.
- Verify that <http://tplinkwifi.net> is correctly entered in the web browser. Alternatively, enter <http://192.168.0.1> or <http://192.168.1.1> in the web browser and press **Enter**.
- Use another web browser and try again.
- Reboot your router and try again.
- Disable and enable the network adapter being used.

#### Q2. What should I do if I cannot access the internet?

- Check if the internet is working normally by connecting a computer directly to the modem using an Ethernet cable. If it is not, contact your internet service provider.
- Log in to the web management page of the router, and go to the **Network Map** to check whether the internet IP address is valid or not. If it is not, check the hardware connection or contact your internet service provider.
- Reboot your router and try again.
- For cable modem users, log in to the web management page of the router. Go to **Advanced > Network > Internet > MAC Clone**, select **Clone Current Device MAC** and click **Save**. Then reboot both the modem and the router.

#### Q3. How do I restore the router to its factory default settings?

- With the router powered on, use a pin to press and hold the **RESET** button on the back until all LEDs turn off.
- Log in to the web management page of the router, go to **Advanced > System > Backup & Restore > Factory Default Restore**, and click **Factory Restore**. The router will restore and reboot automatically.

#### Q4. What should I do if I forget my web management page password?

- If you are using a TP-Link ID to log in, click **Forgot password** on the login page and then follow the instructions to reset it.
- Alternatively, refer to **Q3** to reset your router, then visit <http://tplinkwifi.net> to create a new login password.

#### Q5. What should I do if I forget my wireless network password?

- If you have not changed the default wireless password, it can be found on the label at the bottom of the router.
- Connect a computer directly to the router using an Ethernet cable. Log in to the router's web management page at <http://tplinkwifi.net>, and go to **Wireless > Wireless Settings** to retrieve or reset your wireless password.

### Safety Information

- Keep the device away from water, fire, humidity or hot environments.
- Do not attempt to disassemble, repair, or modify the device.
- Do not use damaged charger or USB cable to charge the device.
- Do not use any other chargers than those recommended.
- Do not use the device where wireless devices are not allowed.
- Adapter shall be installed near the equipment and shall be easily accessible.

TP-Link hereby declares that the device is in compliance with the essential requirements and other relevant provisions of directives 2014/53/EU, 2009/125/EC, 2011/65/EU and (EU)2015/863. The original EU declaration of conformity may be found at <https://www.tp-link.com/ce/>.

🔗 For technical support, the user guide and other information, please visit <https://www.tp-link.com/support/>, or simply scan the QR code.

